

# REPLACEMENT PARTS SUITABLE FOR CEBORA®

CP®160

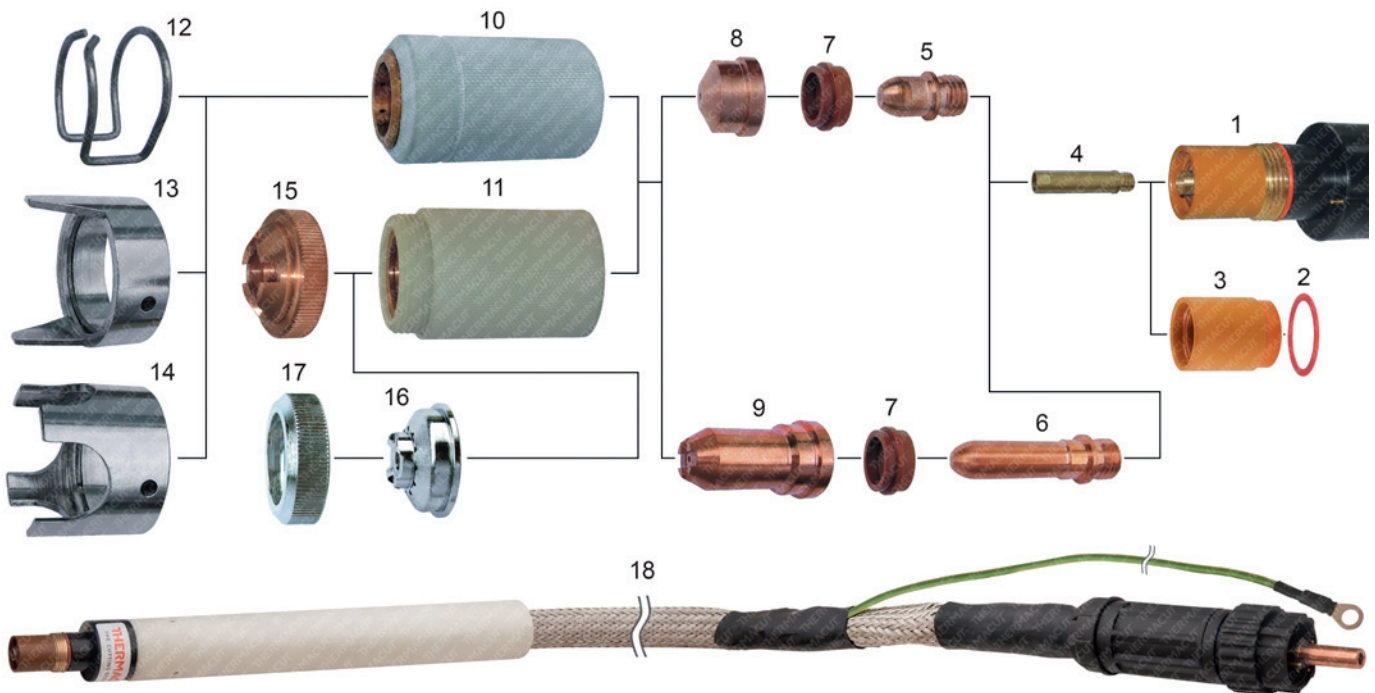

Item	Part No.	Ref. No.	Description	Item	Part No.	Ref. No.	Description
1.	T-8955	1353	Torch Body - Hand	12.	T-0400	1386	Spacer Spring
	T-8746	1354	Torch Body - Machine	13.	T-0643	1408	Double Pointed Spacer
2.	T-0411	1398	O-Ring	14.	T-5003	CV14	Crown Spacer
3.	T-9377	40941	Torch Insulator	15.	T-5401	1392	Shield Cup
4.	T-0410	1378	Brass Diffuser	NS T-5442	1356	Handle with Switch	
5.	T-0408	1376	Electrode	16.	T-9370		Spacer for contact cutting
6.	T-0409	1517	Electrode, Long	17.	T-9375		Locking Nut
7.	T-0407	1377	Swirl Ring	NS KT-1048	1576		CP®160-H Torch with Leads 6m with centr. conn.
	T-8959	1377-CW	Swirl Ring	NS KT-1057	1571		CP®160-H Torch with Leads 6m, fittings
8.	T-0402	1371	Nozzle 1.1mm 50A	NS KT-1070	K.CP160H.6M.CK.K		CP®160-H Cable Leads, Hand.6m with centr. conn.
	T-0403	1372	Nozzle 1.3mm 90A	NS KT-1083	1578		CP®160-H Hand Torch with Leads 12m with centr. conn.
	T-0404	1373	Nozzle 1.6mm 120A	18.	KT-1128	1577	CP®160-M Mach.Torch with Leads 6m with centr. conn.
	T-0405	1374	Nozzle 1.8mm 160A		KT-1086	1579	CP®160-M Mach. Torch with Leads 12m with centr. conn.
9.	T-0406	1369	Nozzle, Long	NS KT-1273	K.CP160M.12M.CK.K		CP®160-M Cable Leads, Mach.12m with centr. conn.
10.	T-0401	1389	Retaining Cap HP, MP150™	NS KT-1419	K.CP160M.12M		CP®160-M Mach. Torch with Leads 12m, fittings
11.	T-5400	1390	Contact Nozzle Ret. Cap HP, MP150™				Different types of cable leads available on request

Last update of this page: 18/11/2016. See Revision history for details.

**THERMACUT®**  
THE CUTTING COMPANY

WWW.THERMACUT.CZ  
TEL.: +420 556 423 418  
SALES@THERMACUT.CZ

WWW.THERMACUT.DE  
TEL.: +49 (0) 27 39 40 33 0  
INFO@THERMACUT.DE

WWW.THERMACUT.COM  
TEL.: 1-603-542-6715  
CUSTOMERSERVICE@THERMACUT.COM

THERMACUT®, FHT-EX® AND EX-TRAFIRE® ARE REGISTERED TRADEMARKS OF THERMACUT S. R. O. AND MAY BE REGISTERED IN CZECH REPUBLIC AND/OR OTHER COUNTRIES. ALL OTHER TRADEMARKS ARE PROPERTIES OF THEIR RESPECTIVE OWNERS. THERMACUT IS NO WAY AFFILIATED WITH CEBORA®. MOST THERMACUT PARTS ARE MADE FOR OR BY AN IBG COMPANY. PARTS INDICATED WITH A OEM ARE ORIGINAL PARTS MANUFACTURED BY THE ABOVE NAMED MANUFACTURER AND ARE BEING RESOLD BY THERMACUT. THERMACUT RESERVES THE RIGHT TO SUBSTITUTE OEM PARTS IN PLACE OF THERMACUT PARTS. VALID FROM NOVEMBER 2016 • PREVIOUS VERSION IS NO LONGER VALID. • © COPYRIGHT 2016 BY THERMACUT® CZECH REPUBLIC. ALL RIGHTS RESERVED.